

# Permit with introductory note

The Environmental Permitting (England & Wales) Regulations 2010

---

Day Group Limited

Day Aggregates Stewarts Lane Facility  
100 Silverthorne Road  
Battersea  
London  
SW8 3EG

Permit number  
EPR/CB3631AD

# Day Aggregates Stewarts Lane Facility

## Permit number EPR/CB3631AD

### Introductory note

#### **This introductory note does not form a part of the permit**

The main features of the permit are as follows. The facility is to be used for the recycling and reclamation, of wastes for the purpose of manufacturing high grade recycled aggregates.

The status log of the permit sets out the permitting history, including any changes to the permit reference number.

| <b>Status log of the permit</b>    |                       |  |
|------------------------------------|-----------------------|--|
| <b>Description</b>                 | <b>Date</b>           | <b>Comments</b>  |
| Application<br>EPR/CB3631AD/A001   | Duly made<br>27/03/12 | Application material recycling<br>facility.                                      |
| Additional information<br>received | 09/05/12              | Amendment to Table 3 of<br>Environmental Risk Assessment<br>(Doc.Day. Bat. B2.7) |
| Permit determined                  | 15/06/2012            | Permit issued to Day Group<br>Limited  |

End of introductory note

# Permit

The Environmental Permitting (England and Wales) Regulations 2010

**Permit number**  
**EPR/CB3631AD**

The Environment Agency hereby authorises, under regulation 13 of the Environmental Permitting (England and Wales) Regulations 2010

**Day Group Limited** (“the operator”),  
whose registered office is

**Day Group House**  
**Transport Avenue**  
**Brentford**  
**Middlesex**  
**TW8 9HF**

company registration number 00432417  
to operate waste operations at

**Day Aggregates Stewarts Lane Facility**  
**100 Silverthorne Road**  
**Battersea**  
**London**  
**SW8 3EG**

to the extent authorised by and subject to the conditions of this permit.

| Name                      | Date              |
|---------------------------|-------------------|
| <b>Clare Palmer Clark</b> | <b>15/06/2012</b> |

Authorised on behalf of the Environment Agency

# Conditions

## 1 Management

### 1.1 General management

1.1.1 The operator shall manage and operate the activities:

- (a) in accordance with a written management system that identifies and minimises risks of pollution, including those arising from operations, maintenance, accidents, incidents, non-conformances, closure and those drawn to the attention of the operator as a result of complaints; and
- (b) using sufficient competent persons and resources.

1.1.2 Records demonstrating compliance with condition 1.1.1 shall be maintained.

1.1.3 Any person having duties that are or may be affected by the matters set out in this permit shall have convenient access to a copy of it kept at or near the place where those duties are carried out.

### 1.2 Avoidance, recovery and disposal of wastes produced by the activities

1.2.1 The operator shall take appropriate measures to ensure that:

- (a) the waste hierarchy referred to in Article 4 of the Waste Framework Directive is applied to the generation of waste by the activities; and
- (b) any waste generated by the activities is treated in accordance with the waste hierarchy referred to in Article 4 of the Waste Framework Directive; and
- (c) where disposal is necessary, this is undertaken in a manner which minimises its impact on the environment.

1.2.2 The operator shall review and record at least every four years whether changes to those measures should be made and take any further appropriate measures identified by a review.

## 2 Operations

### 2.1 Permitted activities

2.1.1 The operator is only authorised to carry out the activities specified in schedule 1 table S1.1 (the "activities").

### 2.2 The site

2.2.1 The activities shall not extend beyond the site, being the land shown edged in green on the site plan at schedule 7 to this permit.

## 2.3 Operating techniques

- 2.3.1 (a) The activities shall, subject to the conditions of this permit, be operated using the techniques and in the manner described in the documentation specified in schedule 1, table S1.2, unless otherwise agreed in writing by the Environment Agency.
- (b) If notified by the Environment Agency that the activities are giving rise to pollution, the operator shall submit to the Environment Agency for approval within the period specified, a revision of any plan specified in schedule 1, table S1.2 or otherwise required under this permit, and shall implement the approved revised plan in place of the original from the date of approval, unless otherwise agreed in writing by the Environment Agency.
- 2.3.2 Waste shall only be accepted if:
- (a) it is of a type and quantity listed in schedule 2 table S2.1 and
- (b) it conforms to the description in the documentation supplied by the producer and holder.

## 3 Emissions and monitoring

### 3.1 Emissions of substances not controlled by emission limits

- 3.1.1 Emissions of substances not controlled by emission limits (excluding odour) shall not cause pollution. The operator shall not be taken to have breached this condition if appropriate measures, including, but not limited to, those specified in any approved emissions management plan, have been taken to prevent or where that is not practicable, to minimise, those emissions.
- 3.1.2 The operator shall:
- (a) if notified by the Environment Agency that the activities are giving rise to pollution, submit to the Environment Agency for approval within the period specified, an emissions management plan;
- (b) implement the approved emissions management plan, from the date of approval, unless otherwise agreed in writing by the Environment Agency.
- 3.1.3 All liquids in containers, whose emission to water or land could cause pollution, shall be provided with secondary containment, unless the operator has used other appropriate measures to prevent or where that is not practicable, to minimise, leakage and spillage from the primary container.

### 3.2 Odour

- 3.2.1 Emissions from the activities shall be free from odour at levels likely to cause pollution outside the site, as perceived by an authorised officer of the Environment Agency, unless the operator has used appropriate measures, including, but not limited to, those specified in any approved odour management plan, to prevent or where that is not practicable to minimise the odour.
- 3.2.2 The operator shall:
- (a) if notified by the Environment Agency that the activities are giving rise to pollution outside the site due to odour, submit to the Environment Agency for approval within the period specified, an odour management plan;
- (b) implement the approved odour management plan, from the date of approval, unless otherwise agreed in writing by the Environment Agency.

### **3.3 Noise and vibration**

- 3.3.1 Emissions from the activities shall be free from noise and vibration at levels likely to cause pollution outside the site, as perceived by an authorised officer of the Environment Agency, unless the operator has used appropriate measures, including, but not limited to, those specified in any approved noise and vibration management plan to prevent or where that is not practicable to minimise the noise and vibration.
- 3.3.2 The operator shall:
- (a) if notified by the Environment Agency that the activities are giving rise to pollution outside the site due to noise and vibration, submit to the Environment Agency for approval within the period specified, a noise and vibration management plan;
  - (b) implement the approved noise and vibration management plan, from the date of approval, unless otherwise agreed in writing by the Environment Agency.

## **4 Information**

### **4.1 Records**

- 4.1.1 All records required to be made by this permit shall:
- (a) be legible;
  - (b) be made as soon as reasonably practicable;
  - (c) if amended, be amended in such a way that the original and any subsequent amendments remain legible, or are capable of retrieval; and
  - (d) be retained, unless otherwise agreed in writing by the Environment Agency, for at least 6 years from the date when the records were made, or in the case of the following records until permit surrender:
    - (i) off-site environmental effects; and
    - (ii) matters which affect the condition of the land and groundwater.
- 4.1.2 The operator shall keep on site all records, plans and the management system required to be maintained by this permit, unless otherwise agreed in writing by the Environment Agency.

### **4.2 Reporting**

- 4.2.1 The operator shall send all reports and notifications required by the permit to the Environment Agency using the contact details supplied in writing by the Environment Agency.
- 4.2.2 Within one month of the end of each quarter, the operator shall submit to the Environment Agency using the form made available for the purpose, the information specified on the form relating to the site and the waste accepted and removed from it during the previous quarter.

## 4.3 Notifications

- 4.3.1 The Environment Agency shall be notified without delay following the detection of:
- (a) any malfunction, breakdown or failure of equipment or techniques, accident, or emission of a substance not controlled by an emission limit which has caused, is causing or may cause significant pollution;
  - (b) the breach of a limit specified in the permit; or
  - (c) any significant adverse environmental effects.

4.3.2 Any information provided under condition 4.3.1 shall be confirmed by sending the information listed in schedule 5 to this permit within the time period specified in that schedule.

4.3.3 The Environment Agency shall be notified within 14 days of the occurrence of the following matters, except where such disclosure is prohibited by Stock Exchange rules:

Where the operator is a registered company:

- (a) any change in the operator's trading name, registered name or registered office address; and
- (b) any steps taken with a view to the operator going into administration, entering into a company voluntary arrangement or being wound up.

Where the operator is a corporate body other than a registered company:

- (a) any change in the operator's name or address; and
- (b) any steps taken with a view to the dissolution of the operator.

4.3.4 Where the operator proposes to make a change in the nature or functioning, or an extension of the activities, which may have consequences for the environment and the change is not otherwise the subject of an application for approval under the Regulations or this permit:

- (a) the Environment Agency shall be notified at least 14 days before making the change; and
- (b) the notification shall contain a description of the proposed change in operation.

## 4.4 Interpretation

4.4.1 In this permit the expressions listed in schedule 6 shall have the meaning given in that schedule.

4.4.2 In this permit references to reports and notifications mean written reports and notifications, except where reference is made to notification being made "without delay", in which case it may be provided by telephone.

## Schedule 1 – Operations

**Table S1.1 activities**

| Description of activities for waste operations   | Limits of activities   |
|--|--|
| <b>D15:</b> Storage pending any of the operations numbered D1 to D14 (excluding temporary storage, pending collection, on the site where it is produced)   | Treatment consisting only of sorting, separation, screening, baling, shredding, crushing, blending or compaction of waste into different components for disposal (no more than 50 tonnes per day) or recovery. |
| <b>R13:</b> Storage of waste pending any of the operations numbered R1 to R12 (excluding temporary storage, pending collection, on the site where it is produced)  | Only inert waste shall be stored and treated on hard standing, all other wastes shall be stored and treated on an impermeable surface with a sealed drainage system.   |
| <b>D9:</b> Physico-chemical treatment not specified elsewhere in Annex IIA which results in final compounds or mixtures which are discarded by means of any of the operations numbered D1 to D8 and D10 to D12 |  |
| <b>R5:</b> Recycling/reclamation of other inorganic materials  |  |
| <b>R4:</b> Recycling/reclamation of metals and metal compounds   |  |
| <b>R3:</b> Recycling/reclamation of organic substances which are not used as solvents  |  |

**Table S1.2 Operating techniques**

| Description     | Parts                                      | Date Received |
|-----------------|--|---------------|
| Application     | Management System – DAY. Bat B2.3d.02      | 27/03/12      |
| Application     | Operating Techniques – DAY. Bat B4.3.09    | 27/03/12      |
| Response to RFI | Amended Risk Assessment – DAY. Bat B2.7.07 | 09/05/12      |



## Schedule 2 - Waste types, raw materials and fuels

**Table 2.1 Permitted waste types and quantities.**

**Maximum Quantities**

The total quantity of waste accepted at the site shall be less than 35,000 tonnes a year.

**Exclusions**

Wastes having the following characteristics shall not be accepted:

- Consisting solely or mainly of dusts, powders or loose fibres;
- Wastes that are in a form which is either sludge or liquid.

| <b>Waste code</b> | <b>Description</b>  |
|-------------------|---|
| <b>01</b>         | <b>WASTES RESULTING FROM EXPLORATION, MINING, QUARRYING, PHYSICAL AND CHEMICAL TREATMENT OF MINERALS</b>            |
| 01 01             | wastes from mineral extraction  |
| 01 01 01          | wastes from mineral metalliferous excavation  |
| 01 01 02          | wastes from mineral non-metalliferous excavation  |
| 01 04             | wastes from physical and chemical processing of non-metalliferous minerals  |
| 01 04 08          | waste gravel and crushed rocks other than those mentioned in 01 04 07   |
| 01 04 09          | waste sand and clays  |
| 01 04 12          | tailings and other wastes from washing and cleaning of minerals other than those mentioned in 01 04 07 and 01 04 11 |
| 01 04 13          | wastes from stone cutting and sawing other than those mentioned in 01 04 07   |
| <b>10</b>         | <b>WASTES FROM THERMAL PROCESSES</b>  |
| 10 09             | wastes from casting of ferrous pieces   |
| 10 09 03          | furnace slag  |
| 10 09 06          | casting cores and moulds which have not undergone pouring other than those mentioned in 10 09 05                    |
| 10 09 08          | casting cores and moulds which have undergone pouring other than those mentioned in 01 09 07                        |
| 10 10             | wastes from casting of non-ferrous pieces   |
| 10 10 03          | furnace slag  |
| 10 10 06          | casting cores and moulds which have not undergone pouring, other than those mentioned in 10 10 05                   |
| 10 10 08          | casting cores and moulds which have undergone pouring, other than those mentioned in 10 10 07                       |
| 10 12             | wastes from manufacture of ceramic goods, bricks, tiles and construction products                                   |
| 10 12 08          | waste ceramics, bricks, tiles and construction products (after thermal processing)                                  |
| 10 12 12          | wastes from glazing other than those mentioned in 10 12 11  |
| 10 13             | wastes from manufacture of cement, lime and plaster and articles and products made from them                        |
| 10 13 14          | waste concrete and concrete sludge  |

|           |  |
|-----------|--|
| <b>15</b> | <b>WASTE PACKAGING; ABSORBENTS, WIPING CLOTHS, FILTER MATERIALS AND PROTECTIVE CLOTHING NOT OTHERWISE SPECIFIED</b>  |
| 15 01     | packaging (including separately collected municipal packaging waste)   |
| 15 01 01  | paper and cardboard packaging  |
| 15 01 07  | glass packaging  |
| <b>17</b> | <b>CONSTRUCTION AND DEMOLITION WASTES (INCLUDING EXCAVATED SOIL FROM CONTAMINATED SITES)</b>   |
| 17 01     | concrete, bricks, tiles and ceramics   |
| 17 01 01  | concrete   |
| 17 01 02  | bricks   |
| 17 01 03  | tiles and ceramics   |
| 17 01 07  | mixtures of concrete, bricks, tiles and ceramics other than those mentioned in 17 01 06  |
| 17 02     | wood, glass and plastic  |
| 17 02 01  | wood   |
| 17 02 02  | glass  |
| 17 03     | bituminous mixtures, coal tar and tarred products  |
| 17 03 02  | bituminous mixtures other than those mentioned in 17 03 01   |
| 17 04     | metals (including their alloys)  |
| 17 04 01  | copper, bronze, brass  |
| 17 04 02  | aluminium  |
| 17 04 03  | lead   |
| 17 04 04  | zinc   |
| 17 04 05  | iron and steel   |
| 17 04 06  | tin  |
| 17 04 07  | mixed metals   |
| 17 05     | soil (including excavated soil from contaminated sites), stones and dredging spoil   |
| 17 05 04  | soil and stones other than those mentioned in 17 05 03   |
| 17 05 08  | track ballast other than those mentioned in 17 05 07   |
| 17 09     | other construction and demolition wastes   |
| 17 09 04  | mixed construction and demolition wastes other than those mentioned in 17 09 01, 17 09 02 and 17 09 03   |
| <b>19</b> | <b>WASTES FROM WASTE MANAGEMENT FACILITIES, OFF-SITE WASTE WATER TREATMENT PLANTS AND THE PREPARATION OF WATER INTENDED FOR HUMAN CONSUMPTION AND WATER FOR INDUSTRIAL USE</b> |
| 19 01     | wastes from incineration or pyrolysis of waste   |

|          |  |
|----------|--|
| 19 01 02 | ferrous materials removed from bottom ash  |
| 19 01 12 | bottom ash and slag other than those mentioned in 19 01 11   |
| 19 01 19 | sands from fluidised beds  |
| 19 12    | wastes from the mechanical treatment of waste (for example sorting, crushing, compacting, pelletising) not otherwise specified                 |
| 19 12 01 | paper and cardboard  |
| 19 12 05 | glass  |
| 19 12 09 | mineral (for example sand, stones)   |
| 19 13    | wastes from soil and groundwater remediation   |
| 19 13 02 | solid wastes from soil remediation other than those mentioned in 19 13 01  |
| 20       | <b>MUNICIPAL WASTES (HOUSEHOLD WASTE AND SIMILAR COMMERCIAL, INDUSTRIAL AND INSTITUTIONAL WASTES) INCLUDING SEPARATELY COLLECTED FRACTIONS</b> |
| 20 01    | separately collected fractions (except 15 01)  |
| 20 01 02 | glass  |

# Schedule 3 – Emissions and monitoring

There are no emission limits or associated monitoring requirements.

# Schedule 4 - Reporting

There is no reporting under this schedule.

## Schedule 5 - Notification

These pages outline the information that the operator must provide.

Units of measurement used in information supplied under Part A and B requirements shall be appropriate to the circumstances of the emission. Where appropriate, a comparison should be made of actual emissions and authorised emission limits.

If any information is considered commercially confidential, it should be separated from non-confidential information, supplied on a separate sheet and accompanied by an application for commercial confidentiality under the provisions of the EP Regulations.

### Part A

|   |  |
|---|--|
| Permit Number   |  |
| Name of operator  |  |
| Location of Facility  |  |
| Time and date of the detection  |  |
| <b>(a) Notification requirements for any malfunction, breakdown or failure of equipment or techniques, accident, or emission of a substance not controlled by an emission limit which has caused, is causing or may cause significant pollution</b> |  |
| <b>To be notified within 24 hours of detection</b>  |  |
| Date and time of the event  |  |
| Reference or description of the location of the event   |  |
| Description of where any release into the environment took place  |  |
| Substances(s) potentially released  |  |
| Best estimate of the quantity or rate of release of substances  |  |
| Measures taken, or intended to be taken, to stop any emission   |  |
| Description of the failure or accident.   |  |
| <b>(b) Notification requirements for the breach of a limit</b>  |  |
| <b>To be notified within 24 hours of detection unless otherwise specified below</b>   |  |
| Emission point reference/ source  |  |
| Parameter(s)  |  |
| Limit   |  |
| Measured value and uncertainty  |  |
| Date and time of monitoring   |  |
| Measures taken, or intended to be taken, to stop the emission   |  |

| <b>Time periods for notification following detection of a breach of a limit</b> |                            |
|---|----------------------------|
| <b>Parameter</b>  | <b>Notification period</b> |
|   |                            |
|   |                            |
|   |                            |

| <b>(c) Notification requirements for the detection of any significant adverse environmental effect</b> |  |
|--|--|
| <b>To be notified within 24 hours of detection</b>   |  |
| Description of where the effect on the environment was detected  |  |
| Substances(s) detected   |  |
| Concentrations of substances detected  |  |
| Date of monitoring/sampling  |  |

**Part B - to be submitted as soon as practicable**

|  |  |
|--|--|
| Any more accurate information on the matters for notification under Part A.  |  |
| Measures taken, or intended to be taken, to prevent a recurrence of the incident   |  |
| Measures taken, or intended to be taken, to rectify, limit or prevent any pollution of the environment which has been or may be caused by the emission |  |
| The dates of any unauthorised emissions from the facility in the preceding 24 months.  |  |

|                  |  |
|------------------|--|
| <b>Name*</b>     |  |
| <b>Post</b>      |  |
| <b>Signature</b> |  |
| <b>Date</b>      |  |

\* authorised to sign on behalf of the operator

## Schedule 6 - Interpretation

“*accident*” means an accident that may result in pollution.

“*Annex I*” means Annex I to Directive 2008/98/EC of the European Parliament and of the Council on waste.

“*Annex II*” means Annex II to Directive 2008/98/EC of the European Parliament and of the Council on waste.

“*application*” means the application for this permit, together with any additional information supplied by the operator as part of the application and any response to a notice served under Schedule 5 to the EP Regulations.

“*authorised officer*” means any person authorised by the Environment Agency under section 108(1) of The Environment Act 1995 to exercise, in accordance with the terms of any such authorisation, any power specified in section 108(4) of that Act.

“*D*” means a disposal operation provided for in Annex I to Directive 2008/98/EC of the European Parliament and of the Council on waste.

“*emissions of substances not controlled by emission limits*” means emissions of substances to air, water or land from the activities, either from the emission points specified in schedule 3 or from other localised or diffuse sources, which are not controlled by an emission limit..

“*emissions to land*” includes emissions to groundwater.

“*EP Regulations*” means The Environmental Permitting (England and Wales) Regulations SI 2010 No.675 and words and expressions used in this permit which are also used in the Regulations have the same meanings as in those Regulations.

“*groundwater*” means all water, which is below the surface of the ground in the saturation zone and in direct contact with the ground or subsoil.

“*MCERTS*” means the Environment Agency’s Monitoring Certification Scheme.

“*quarter*” means a calendar year quarter commencing on 1 January, 1 April, 1 July or 1 October.

“*R*” means a recovery operation provided for in Annex II to Directive 2008/98/EC of the European Parliament and of the Council on waste.

“*Waste code*” means the six digit code referable to a type of waste in accordance with the List of Wastes (England) Regulations 2005, or List of Wastes (Wales) Regulations 2005, as appropriate, and in relation to hazardous waste, includes the asterisk.

“*year*” means calendar year ending 31 December.



# Schedule 7 - Site plan

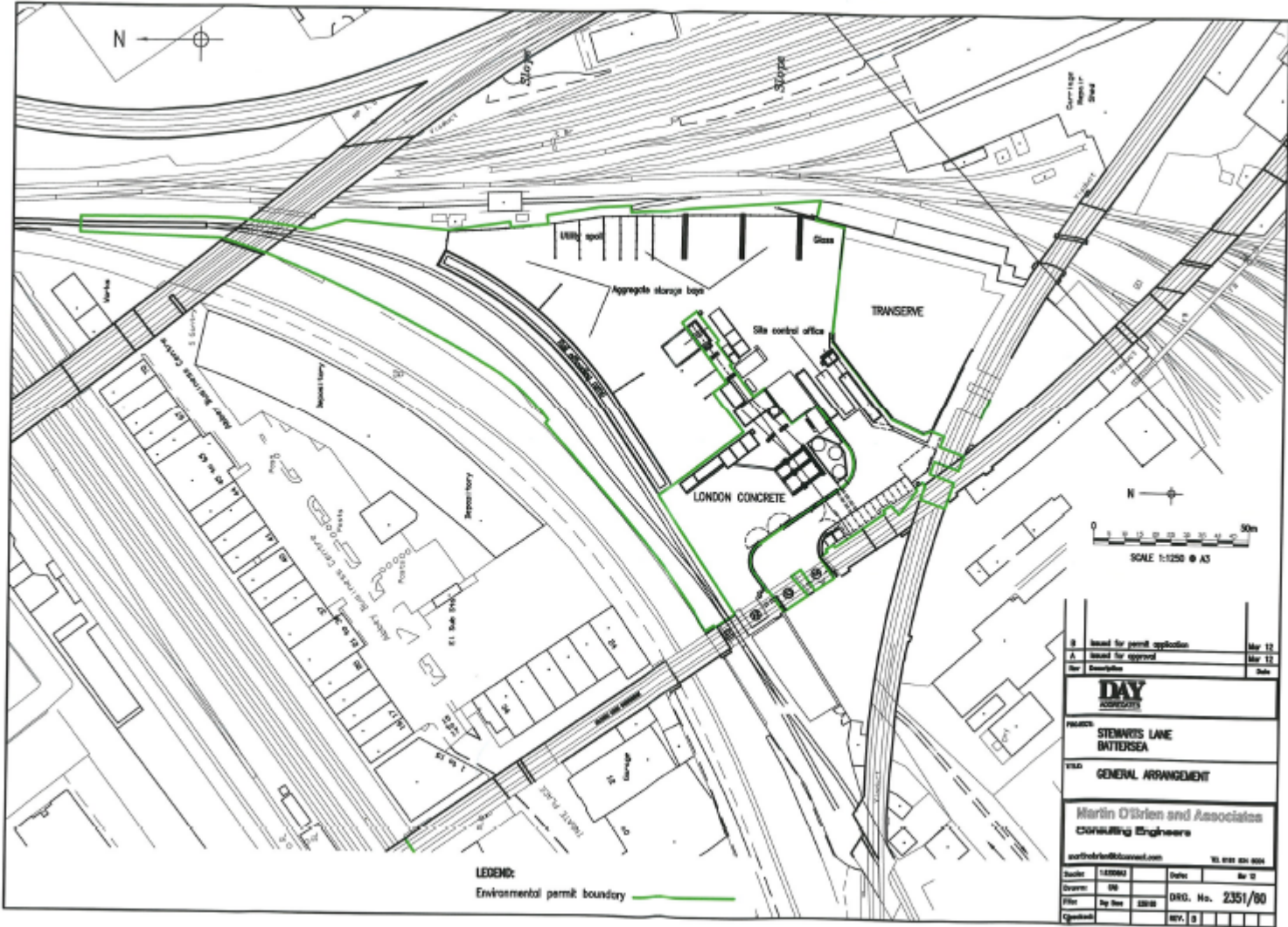

END OF PERMIT